

S.A.C. Silent Grey-Line Documentary



S.A.C. Silent AG

Alti Ruedelfingerstrass 28
CH-8460 Marthalen

Tel. +41 41 448 40 00
Fax +41 41 448 40 09

info@sac-silent.com
www.sac-silent.com



S.A.C. Silent - Grey-Line suspended jointless acoustic system

The Grey-Line system is designed for rooms with a suspended ceiling construction. The basic components of the jointless acoustic system are formed by the AMF silent panel. This is attached directly to the CD 60x27 substructure. Two acoustically effective coatings are then applied to the panels.

- Optimum acoustic properties
- Simple processing thanks to tongue and groove
- Aesthetic surface elegance
- Low installation height
- Flexible application possibilities
- Good processing

System structure Grey-Line

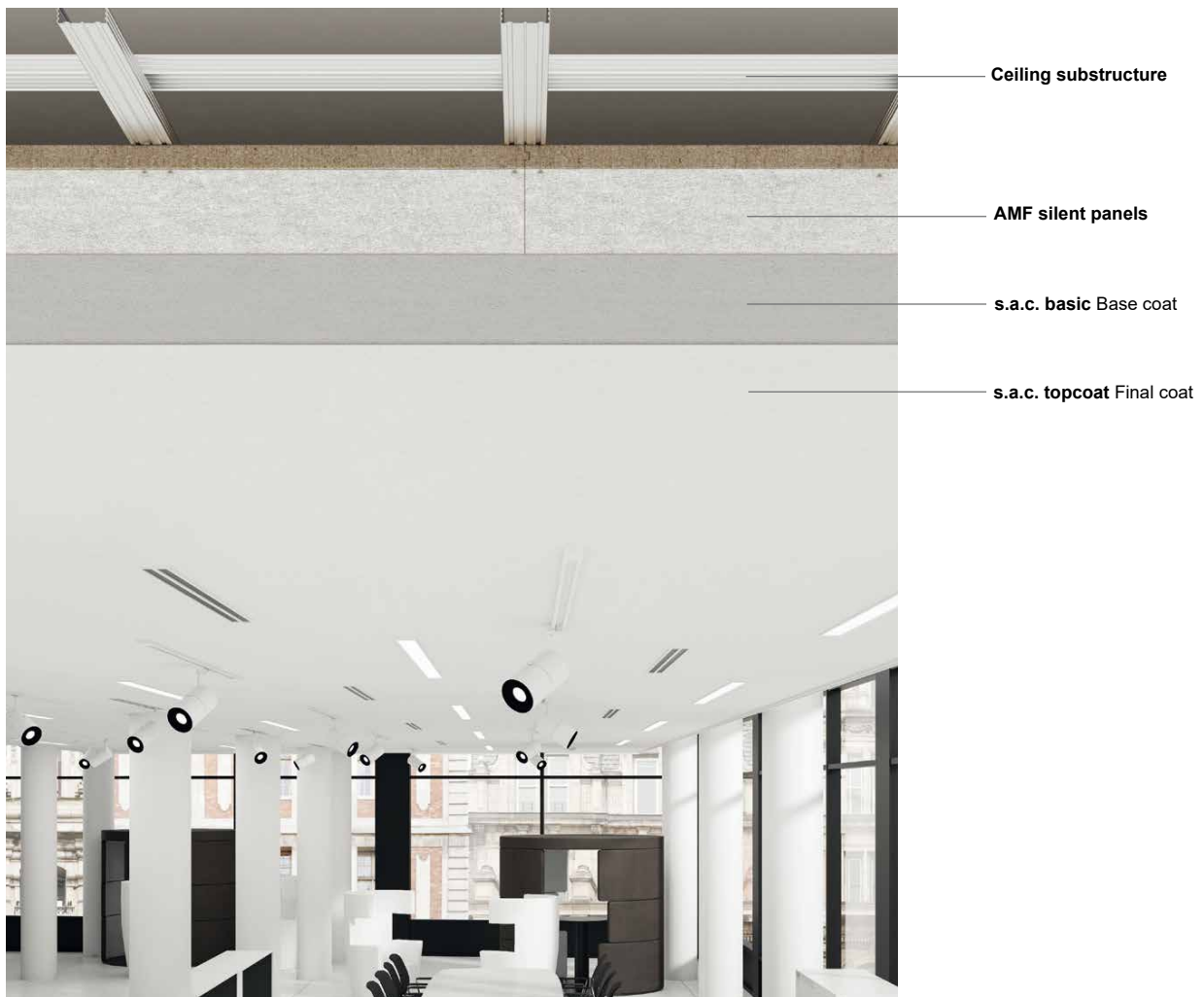

Grey-Line system structure on CD 60x27 metal substructure

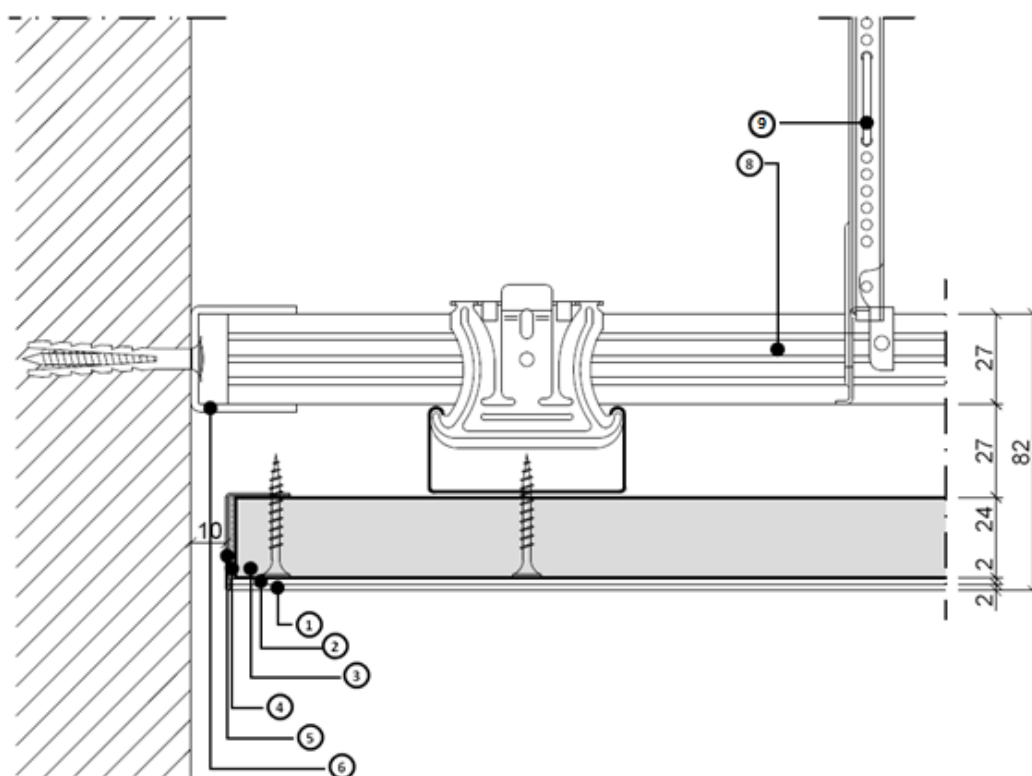

Execution panels joint

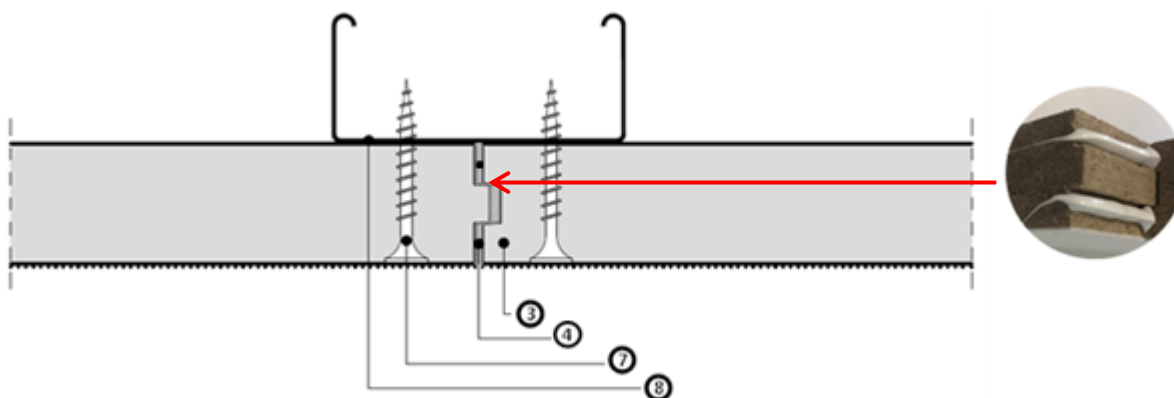

NOTE: The panel front side must be absolutely dust-free before gluing. .

Legend

- ① s.a.c. topcoat Final coat
- ② s.a.c. basic Base coat
- ③ AMF silent panel
- ④ Knauf Power Elast Acryl-Glue
- ⑤ Angle profile 30x30mm with
- ⑥ Wall profile 27/28/27
- ⑦ Aquapanel Maxi screw SN39
- ⑧ Basic and supporting profile
- ⑨ Suspension

System weight

AMF silent Panels [kg/m ²]	Basic coat [kg/m ²]	Topcoat [kg/m ²]	Total weight [kg/m ²]
8.4	2	1-2	11.4

Ceiling installations

Weight	Fasteners	Notice
≤ 1,0 kg/m ² (as point load)	cavity fixing	max. 2 point load / m ²
≤ 10 kg/m ² (as point load)	direct fixing	Directly into the Metal-UK or by a replacement with CD-profiles
> 10 kg/m ² (as point load)	direct fixing	Fasten directly to the concrete ceiling

Classification Report

Reaction to fire classification according to EN 13501-1:2007 the jointless acoustic system Grey-Line corresponds to the material class A2-s1,d0.

Dies bedeutet, das Material ist nichtbrennbar ohne Anteile von brennbaren Baustoffen.

Coloured ceilings

The standard surfaces are similar to NCS S 0500-N. The top layer can also be dyed in various NCS colours.

Sound absorption coefficient

suspended, 200mm

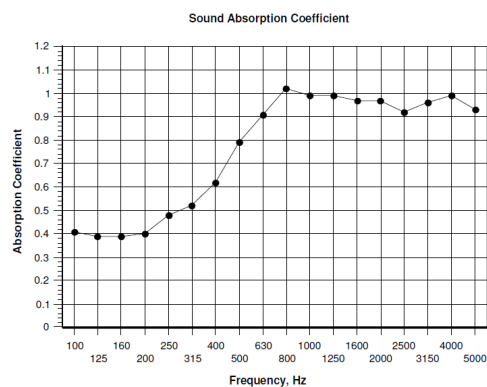

suspended, 100mm

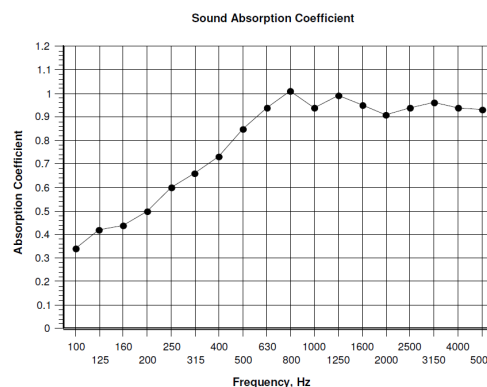

The absorption values illustrated illustrate the effectiveness of the system and serve acousticians and building physicists to determine the optimum reverberation time in the room. The measured values are based on laboratory measurements, which can vary depending on processing and object conditions.